



**Pier 40 Structural Restoration – Phase 3
Invitation for Bids (IFB)
Project/Contract #C4873
Addendum No. 1
January 3, 2019**

To All Bidders:

- 1. The above referenced IFB is hereby amended to include the Site Logistics Plan attached hereto as Attachment A.**
- 2. Sheet S502 (Concrete Repair Schedule) of the Issued for Bid Drawings in the above referenced IFB is hereby deleted in its entirety and replaced with Attachment B herein.**
- 3. All requirements of the original IFB shall remain in full force and effect, except as set forth in this Addendum and any other previously issued Addenda.**
- 4. All capitalized terms set forth in this Addendum shall have the same meaning as set forth in the IFB being amended hereby.**

THIS ADDENDUM MUST BE SIGNED BY THE BIDDER AND ATTACHED TO THE BID WHEN SUBMITTED.

HUDSON RIVER PARK TRUST

By: Kevin Quinn

Title: Senior Vice President

ACKNOWLEDGED AND AGREED:

Name of Bidder: _____

By: _____

Title: _____

Date: _____

ATTACHMENT A
SITE LOGISTICS PLAN
(SEPARATE ATTACHMENT)

Install temporary fencing and gate under C4873 contract. This shared (C4873 & C4874) staging area is to be used for a construction trailers, etc

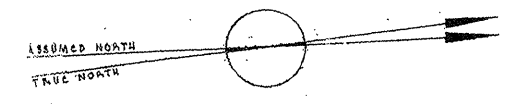

C4873 and C4874 Logistics Plan

The concrete trucks and other construction vehicles can only travel on the pier and in front of the building when accompanied by two flagmen (front and back)

In the event of temporary closure of any public spaces on the pier, such as during a concrete pour, the contractor is responsible for set up and removal of detour barricades and signs.

North Pier apron will not be available for concrete pour staging (see Work Restrictions section of the project manual).

No dive equipment mobilization the pier aprons will be allowed. All staging is to be located on barges (see Work Restrictions section of the project manual)

Blue Arrows - Concrete Truck Access

C4874 concrete pump shall be set-up inside the pedestrian tunnel. C4874 discharging concrete trucks shall occupy a 11'x35' sidewalk area as shown. Maintain pedestrian access through the tunnel at all times during the concrete pour, inclusive of pedestrian shielding adjacent to the pump.

C4874 contractor will set up and remove temporary barricades and signs for pump and truck staging for each concrete pour day.

C4874 contractor is to relocate the jersey barrier, fence, and one gate approximately 5' east of the current location

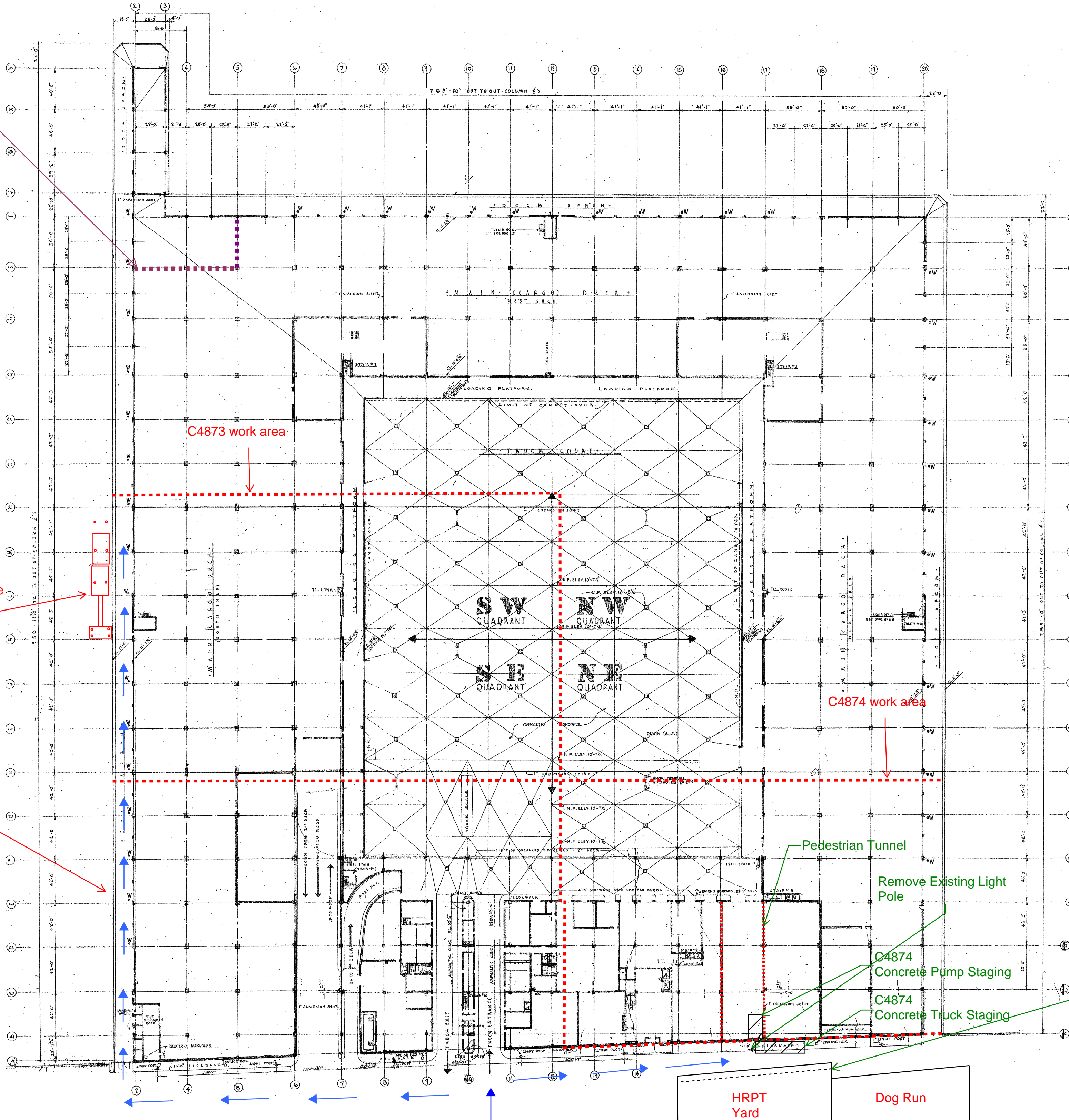

C4873 work area

C4874 work area

Pedestrian Tunnel

Remove Existing Light Pole

C4874 Concrete Pump Staging

C4874 Concrete Truck Staging

HRPT Yard

Dog Run

Existing floating docks, ramp, and platform are to be removed by C4873 contractor, guide piles extracted. All salvaged materials relocated and reinstalled in the same configuration appropriately 240' east of the current location. The components to be removed and relocated are as follows:

1. 13.5'x7' timber platform
2. Two 30'x10' wood/plastic docks
3. 25'x3' aluminum ramp
4. Ten (10) 12" diameter (80' long) steel guide piles

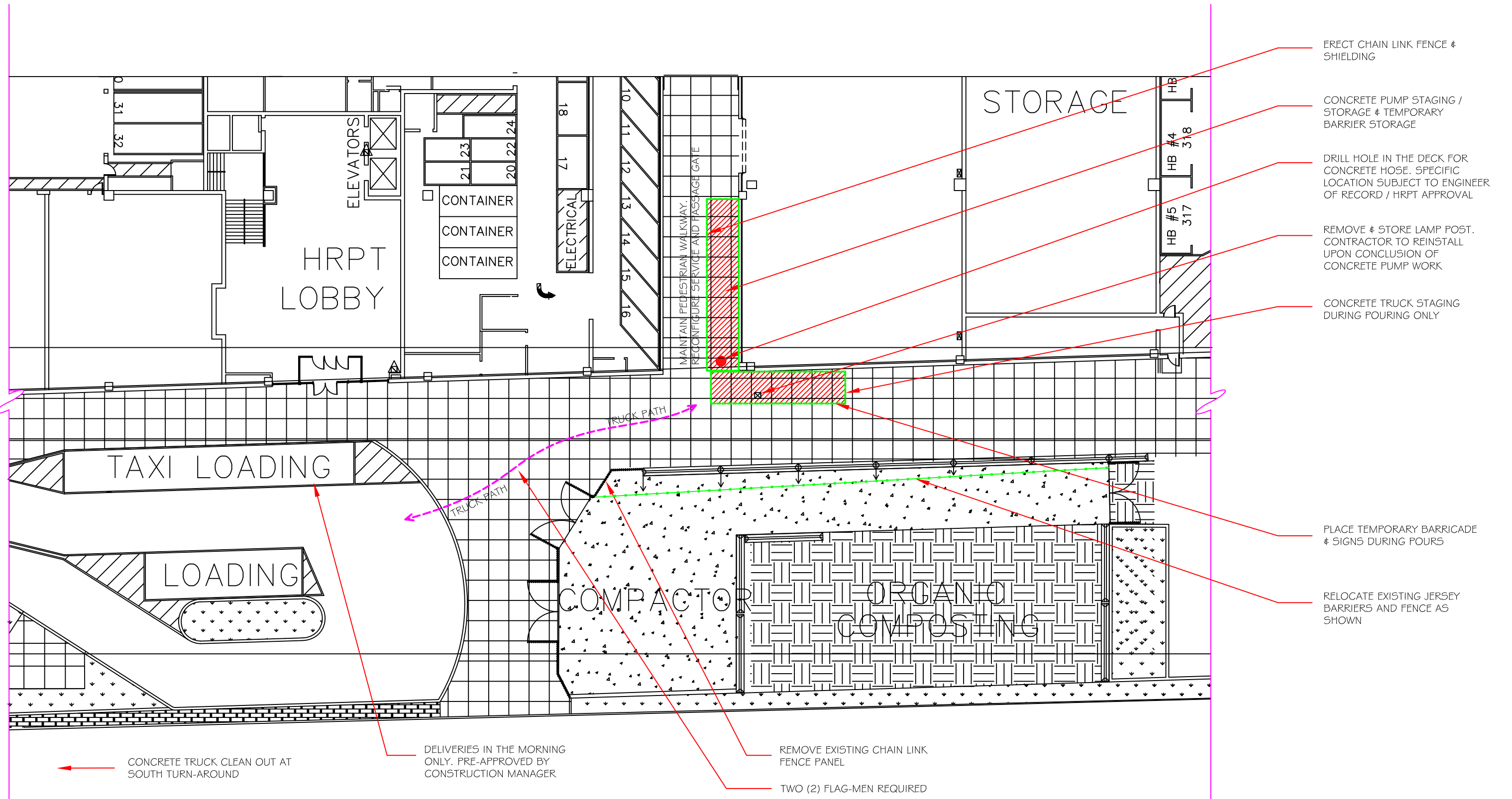

C4874 LOGISTICS FRONT OF PIER 40

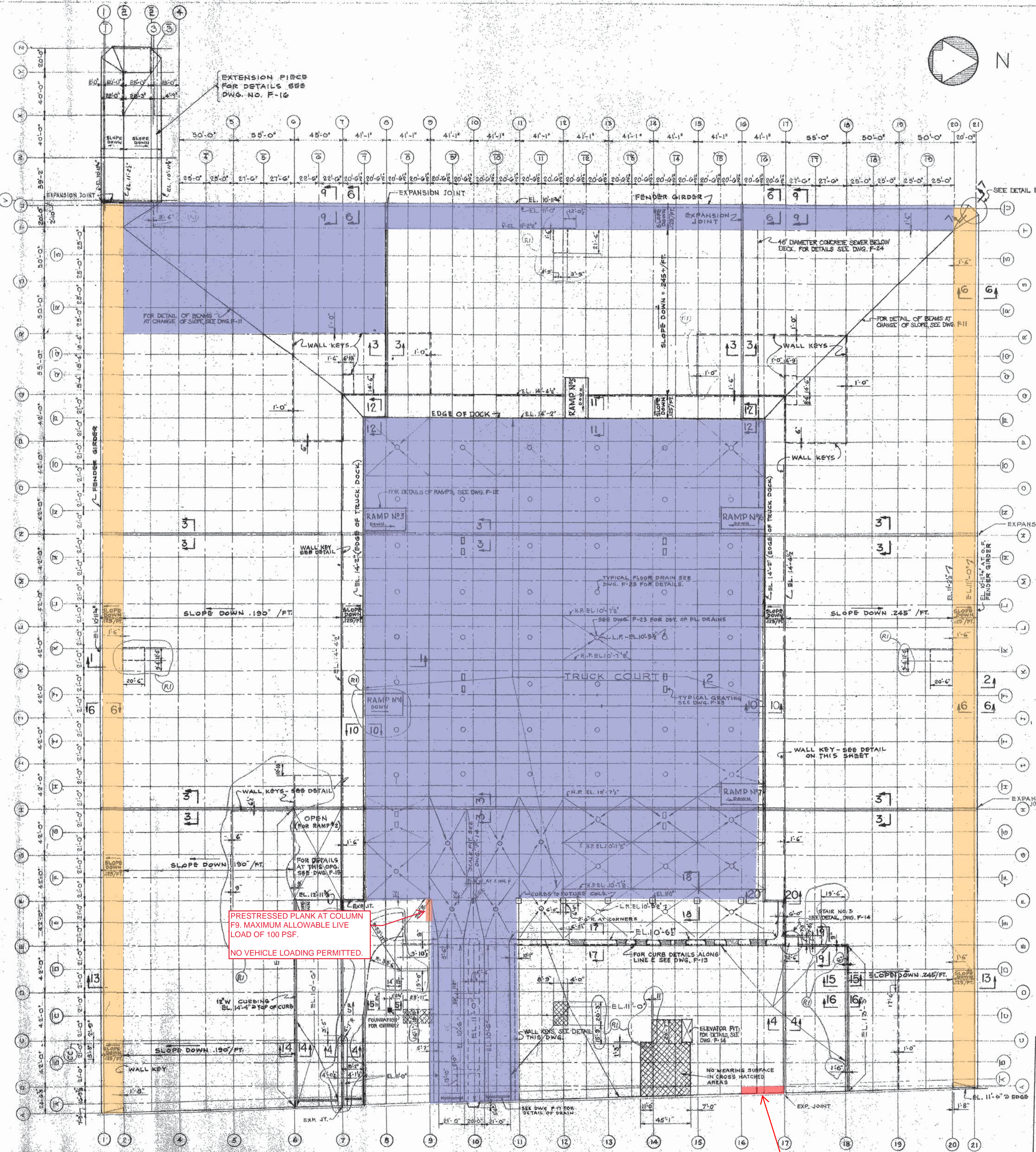
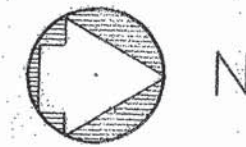

NOTES

- 1- FOR SECTIONS 1 TO 5, SEE DWG. F-11.
- 2- FOR SECTIONS 6 TO 12, SEE DWG. F-12.
- 3- FOR SECTIONS 13 TO 20, SEE DWG. F-13.
- 4- FOR DETAIL 1, SEE DWG. F-12.
- 5- ELEVATIONS SHOWN ARE TO TOP OF FINISHED WEARING SURFACE.
- 6- PROVIDE TEMPORARY PROTECTION FOR KEYS UNTIL WORK ON THE SUPERSTRUCTURE IS BEGUN.
- 7- LOCATION OF WALL KEYS IS INDICATED ON PLAN BY DASHED LINE. DIMENSIONS ARE TO $\frac{1}{2}$ OF KEY.

LEGEND:

- MAXIMUM REAR AXLE/TANDUM AXLE LOAD OF 46 KIPS
- MAXIMUM REAR AXLE/TANDUM AXLE LOAD OF 34.5 KIPS
- ENTIRE PIER DECK RATED FOR A LIVE LOAD OF 100 PSF

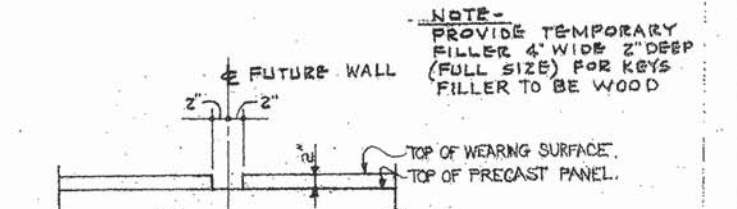

DETAIL OF TYPICAL WALL KEY
(INDICATED ON PLAN BY DASHED LINE)

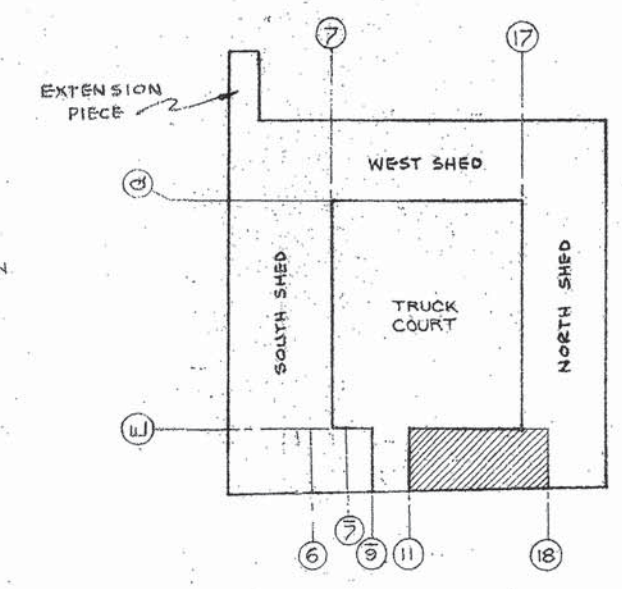

DESIGN LOADS
UNSHADED AREA-600 PSF LIVE LOAD.
SHADED AREA-300 PSF LIVE LOAD OR 15" WHEEL LOAD.
CROSSHATCHED AREA-200 PSF LIVE LOAD.

NO.	DESCRIPTION	DATE	APPROVAL
R1	RELOCATED RAMP N# 4 & WALL KEYS; ADD CURB		

REVISIONS

THE CITY OF NEW YORK
DEPARTMENT OF MARINE AND AVIATION

NEW PIER 40
NORTH RIVER
BOROUGH OF MANHATTAN

ROBERTS AND SCHAEFER CO.
CONSULTING ENGINEERS, NEW YORK, N.Y.
R.P. Schaefer
KARSUNKY, WELLS AND GOUGH
MECHANICAL ENGINEERS, NEW YORK, N.Y. *D.A. Karsunky*

DRAWN BY: P.S.
CHECKED BY: WTH
DATE: 12-4-57 SCALE: 3/8"=1'-0" CONTRACT NO: 3003 R

County MANHATTAN
Block 652
Lot 4

PLAN OF FINISHED FLOOR F-2

CONTRACTOR CAN CORE 8" DIAMETER HOLE THROUGH SLAB BETWEEN BENTS A AND A.

ATTACHMENT B

AMENDED AND RESTATED SHEET S502 – CONCRETE REPAIR SCHEDULE

(SEPARATE ATTACHMENT)

DEFECT ID	ELEMENT	BENT	PILE	REPAIR TYPE	DEFECT NOTES			CRACK NOTES		NOTES	
					DETERIORATE D AREA (SF)	DEPTH (IN)	NO. BARS/(STRANDS) EXPOSED	LENGTH (FT)	WIDTH (IN)		
1	BEAM	H	1.8E	TYPE 3	4					REMOVE HANGER AND STEEL BEAM	
2	UNDERDECK	H.2	1.9	TYPE 6	2	3				REMOVE HANGER AND STEEL BEAM	
3	BEAM	H	2.7E	CRACK				3	1/4		
4	BEAM	H	3.1E	CRACK				3	1/4		
5	PILE CAPITAL	H	3.2E	TYPE 4							
6	PILE CAPITAL	H	5.5E	CRACK							
7	PILE CAPITAL	H	5.3E	TYPE 4							
8					N.I.C.						
9	BEAM	H	7.8E	TYPE 3	27					REMOVE STEEL SECTION TO ACCOMMODATE REPAIR	
10	PILE CAPITAL	H	8.8E	CRACK				3	1/8		
11					N.I.C.						
12	PILE CAPITAL	H	9.7	TYPE 3	4	3					
13					N.I.C.						
14	PILE CAPITAL	H	11W	TYPE 4			1				
15	PILE CAPITAL	H	11	TYPE 4			2				
16	PILE CAPITAL	H	8.8W	TYPE 4							
17	BEAM	H	9.5	TYPE 3	2	2	3				
18	BEAM	H	5.2W	TYPE 3	7	2				REMOVE STEEL SECTION TO ACCOMMODATE REPAIR	
19	PILE CAPITAL	H	5.3W	CRACK				3	3/8		
20					N.I.C.						
21	PILE CAPITAL	H	5'	TYPE 4							
22	PILE CAPITAL	I	11	TYPE 4							
23	BEAM	I	11.4	TYPE 3	4	1	2				
24					N.I.C.						
25					N.I.C.						
26	UNDERDECK	I.8	1.9	TYPE 1	2	4	(1)			REMOVE HANGER AND STEEL BEAM	
27	PILE CAPITAL	J		TYPE 6	1	3	1				
28	PILE CAPITAL	I	4.2	TYPE 4							
29	PILE CAPITAL	J	5.7	CRACK				2	1/4		
30	PILE CAPITAL	J	5.3	CRACK				2	1/4		
31	PILE CAPITAL	J	5.8	CRACK				2	1/4		
32	PILE CAPITAL	J	6'	CRACK				3	1/4		
33	UNDERDECK	I.8	7.9	TYPE 3	2	6	(1)				
34	PILE CAPITAL	J	9	TYPE 4							
35					N.I.C.						
36					N.I.C.						
37					N.I.C.						
38	PILE CAPITAL	J	5.2	CRACK				2	1/4		
39	PILE CAPITAL	J	5.5	CRACK				2	1/4		
40	PILE CAPITAL	J	5'	CRACK				2	1/4		
41	BEAM	J	2.7	TYPE 6	4	3					
42	BEAM	J.1	1	TYPE 3	2	3	2				
43	BEAM	J	2	TYPE 3	3	4	1				
44	BEAM	K	4.3	TYPE 3	7						
45	UNDERDECK	J.2	7.8	TYPE 1	1	5	(2)				
46	PILE CAPITAL	K	9	TYPE 4							
47	PILE CAPITAL	J	9	TYPE 4							
48	PILE CAPITAL	K	11	TYPE 4							
49	BEAM	K	11.2	TYPE 3	1	3	3				
50	BEAM	K	9.5	TYPE 3	10	2	4				
51	PILE CAPITAL	K	9	TYPE 4							
52	BEAM	K	8.5	TYPE 3	14	2	3				
53	BEAM	K	8.5	CRACK				20	1/4	3 CRACKS	
54	PILE CAPITAL	K	5.8	CRACK				2	1/4		
55	BEAM	K	4.7	TYPE 3	5						
56	UNDERDECK	K.7	1.9	TYPE 1	3	4	(3)			AT DECK DRAIN. DO NOT BLOCK DRAIN	
57	PILE CAPITAL	L	1	CRACK				2	1/4	BOLLARD HARDWARE AT REPAIR LOCATION	
58	BEAM	L	1.5	TYPE 3	13						
59					N.I.C.						
60	PILE CAPITAL	K	4.7	TYPE 4							
61	PILE CAPITAL	K	4.2	TYPE 4							
62	PILE CAPITAL	L	9	NO REPAIR							
63	BEAM	L	11.6	TYPE 3	1	2	1				
64	BEAM	L	12.7	TYPE 3	4	3	3				
65	BEAM	L	12.7	TYPE 3	2	3	1				
66	BEAM	L	11.7	TYPE 3	4	1	3				
67					N.I.C.						
68	PILE CAPITAL	M	1	CRACK				2	1/8	BOLLARD HARDWARE AT REPAIR LOCATION	
69	BEAM	M	1.5	TYPE 3	14						
70					N.I.C.						
71	PILE CAPITAL	M	5.7	TYPE 4							
72	PILE CAPITAL	M	5.3	TYPE 4							
73	PILE CAPITAL	M	5.8	TYPE 4							
74	UNDERDECK	L.8	6.7	TYPE 1	10	2	(3)			AT DECK DRAIN. DO NOT BLOCK DRAIN	
75					N.I.C.						
76	PILE CAPITAL	L	11	TYPE 4							
77					N.I.C.						

DEFECT ID	ELEMENT	BENT	PILE	REPAIR TYPE	DEFECT NOTES			CRACK NOTES		NOTES	
					DETERIORATE D AREA (SF)	DEPTH (IN)	NO. BARS/(STRANDS) EXPOSED	LENGTH (FT)	WIDTH (IN)		
78	PILE CAPITAL	M	11	TYPE 4						TWO TYPE 4 REPAIRS AT THIS LOCATION	
79	PILE CAPITAL	M	10	TYPE 4							
80	PILE CAPITAL	M	5.5	TYPE 4						TWO TYPE 4 REPAIRS AT THIS LOCATION	
81	PILE CAPITAL	M	5.7	TYPE 4							
82					N.I.C.						
83	UNDERDECK	M.4	1.7	TYPE 1	2	2	(4)			REMOVE HANGER AND STEEL BEAM	
84	BEAM	M.7	1.2	TYPE 3	3	2				REMOVE FAILING REPAIR	
85	UNDERDECK	M.8	2.2	TYPE 6	4	6					
86	BEAM	N	2.4E	TYPE 3	10	6	9			REMOVE STEEL SECTION TO ACCOMMODATE REPAIR	
87	BEAM	N	3E	TYPE 3	10	6	4			REMOVE STEEL SECTION TO ACCOMMODATE REPAIR	
88	BEAM	N	3W	TYPE 3	7	6	4			REMOVE STEEL SECTION TO ACCOMMODATE REPAIR	
89	BEAM	N	3.4E	TYPE 3	3	2	2			REMOVE STEEL SECTION TO ACCOMMODATE REPAIR	
90	PILE CAPITAL	M	5.5	CRACK				3	1/2	TYPE 4 AT WEST FACE AND CRACK REPAIR AT SOUTHEAST	
91	BEAM	N	5.9E	TYPE 3	1	1	1				
92	BEAM	N	6.5	TYPE 3	20	3	15				
93					N.I.C.						
94	BEAM	N	7.3E	TYPE 3	1	2	3				
95	BEAM	N	7.5W	TYPE 3	2	4	2			VOIDS FILLED W/ STYROFOAM TO BE REMOVED. SPALLS TO BE REPAIRED LOCATED ON BOTH SIDES OF BEAM.	
96	PILE CAPITAL	N	8.8	TYPE 4							
97	PILE CAPITAL	M	11	TYPE 4							
98	PILE CAPITAL	N	11E	TYPE 4							
99	BEAM	N	6.5E	TYPE 3	1	2	1				
100	BEAM	N	4.8W	TYPE 3	5	1	7				
101	UNDERDECK	N.2	2.3	TYPE 1	2	4	(1)			REMOVE HANGER AND STEEL BEAM	



The Honorable
Andrew M. Cuomo
Governor, State of New York

The Honorable
Bill de Blasio
Mayor, City of New York

The Honorable
Gale A. Brewer
Manhattan Borough President

Diana L. Taylor
Chair
Hudson River Park Trust

Alicia Glen
Vice Chair
Hudson River Park Trust

Madelyn Wils
President & CEO
Hudson River Park Trust

Rose Harvey
Commissioner
New York State Office of Parks,
Recreation and Historic Preservation

Mitchell J. Silver
First Deputy Commissioner,
New York City
Parks & Recreation

Basil Seggos
Commissioner
New York State Department of
Environmental Conservation

HUDSON RIVER PARK

PIER 40 STRUCTURAL RESTORATION PHASE 3 C4873

Structural Engineers:
ch2m.
500 7th Avenue
NY, NY 10018
tel: 646 908 6550

sub-consultant:
INSIGHT ENGINEERING
222 BROADWAY 19TH FL.
NEW YORK NY 10038
OFFICE: 844.884.9664

sub-consultant:
KS ENGINEERING, P.C.
434 BROAD STREET, 4TH FLOOR
NEWARK, NJ 07102
tel: 973.623.2999
fax: 973.242.2955

No.	Date	Revision
1	12/20/2018	

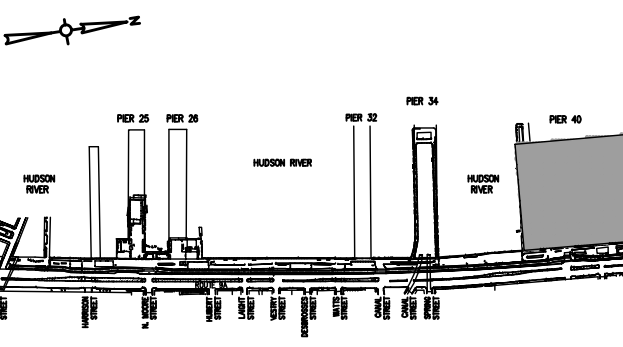

CONCRETE REPAIR SCHEDULE

NOTE:
1. IF DISCREPANCY BETWEEN REPAIR PLAN AND REPAIR SCHEDULE EXISTS, SCHEDULE SHALL CONTROL.